



University of Anbar

Anbar Journal Of Engineering Science©

journal homepage: [http:// www.uoanbar.edu.iq/Evaluate/](http://www.uoanbar.edu.iq/Evaluate/)



Progressive Collapse Analyses of Buildings Subjected to Earthquake Loads

Fareed H. Mosawi, Haider S. Al-Jubair, Hussein A. Ahmed

Department of Civil Engineering, College of Engineering, University of Basrah, Basrah, Iraq

PAPER INFO

Paper history:

Received 13/12/2020

Revised 19/01/2021

Accepted 22/02/2021

Keywords:

Progressive collapse, Concrete buildings, Seismic load, Non-linear dynamic analysis, Plastic hinge.

ABSTRACT

Progressive collapse is a partial or total failure of a building that mostly occurs when the building loses primary structural elements (typically columns) due to accidental or natural hazards. The failure of structures due to an earthquake is one of the most important and frequent types of progressive collapse. In this study, the finite element method is used to assess the response of multistory reinforced concrete buildings subjected to column loss during an earthquake. Three-dimensional nonlinear dynamic analyses are carried out using SAP2000 V.20 program. The effects of different parameters on the progressive collapse behavior are investigated, namely: the location of the removed column within the ground floor; the method of column removal (sudden, in two-steps, and in four-steps) and the removal timing during the earthquake. It is demonstrated that the collapse occurs when all or most of the hinges at the bases of the ground floor columns reach their collapse level. The chosen column removal timing and policy affect the structural behavior considerably. It is realized that, the risk of building collapse increases when the removal timing harmonizes with the peak ground acceleration timing. Based on the adopted earthquake characteristics and building configurations, it is found that, the two steps removal scenario is the most dangerous one.

© 2014 Published by Semnan University Press. All rights reserved.

1. Introduction

Progressive collapse happens when one or more primary structural component (typically vertical load-carrying members) is failed. This failure could be because of an explosion, earthquake, vehicle impact, fire, or other human errors or natural hazards. The failure of a member in the structure leads to redistribution and transfer the load to neighboring members. If these members are not capable to resist the additional load, that part of the structure will be failed. This action continues in the structure until whole structural elements collapse or a large part of it. As a result, the overall damage is disproportionate with the initial

damage [1, and 2]. Since the partial collapse of the Ronan Point Building in England in 1968 due to a gas explosion near the corner of the building on the 18th floor and the collapse of Alfred Murrah Federal building in USA in Oklahoma City 1995 due to a terrorist attack, many codes and standards discussed progressive collapse under abnormal loads. Each of them presented different approaches and design guidelines to prevent or mitigate the potential for progressive collapse in buildings. British standard (BS 8110) was the first standard to address progressive collapse. It had presented several approaches to enhance ductility, continuity, and structural redundancy [3]. American

* Corresponding author : Fareed H. Mosawi : fhmfareed@gmail.com ; +964 780 1011 614

code (ACI 318-08) included requirements in the details of reinforcement recommendations to improve structural integrity and enhance ductility in the structure [4]. (ASCE 7-05) introduced a section entitled (General structural integrity), the intent of it is to improve the general structural integrity in order to carry loads around the damaged members [5]. The main two guidelines that have presented an explicit approach for progressive collapse analysis and design are General Services Administration (GSA 2003) and Department of Defense (DOD 2005). Alternate load path method (ALP) was adopted in both guidelines for progressive collapse assessment in which the structure should be capable to transfer load over the removed vertical member. According to this method, progressive collapse analysis can be linear static, nonlinear static, linear dynamic and nonlinear dynamic analysis [1, and 2].

Marjanishvili, et al. [6] compared the four analysis methods for progressive collapse by analyzing 9-storey steel moment-resisting frame building using SAP2000. The results showed that the dynamic analysis method was more accurate compared to the static method. Tsai, et al. [7] evaluated the potential of an earthquake-resistant reinforced concrete building for progressive collapse under four threat independent column removal conditions by using the linear static analysis method as per GSA. The results concluded that the building had a low potential for progressive collapse. Said, et al. [8] conducted a comparison between GSA (2003) and DOD (2005). Seven-storey reinforced concrete building was analyzed using a nonlinear static method. The results showed that the load percentages at which the collapse occurred adopting the DOD procedure were less than their counterparts from the GSA procedure. Patel [9] performed nonlinear static and nonlinear dynamic progressive collapse analyses for a 15-storey moment resistant reinforced concrete building designed according to Indian standards. The results showed that the nonlinear dynamic analysis procedure was the most efficient method for progressive collapse analysis. El-shaer et al. [11] studied the progressive collapse of a ten-storey reinforced concrete building designed according to Egyptian code. Three-dimensional nonlinear dynamic analyses using (Applied Element Method) were conducted for a building that lost a column during an earthquake. It was proved that, the column loss under seismic load was more critical than the gravity load. The study also illustrated the important effect of including the catenary action of the slab in progressive collapse resistance.

2. Objective

Although the progressive collapse due to seismic action is important and repeatedly occurred, still it has not received much attraction. The main objective of this study is to investigate the response of a multi-storey reinforced concrete buildings subjected to sudden and gradual column loss during an earthquake. Nonlinear dynamic analysis (time history analysis) is carried out using SAP2000 program to follow the step by step progressive collapse of the building during seismic loading, and to evaluate the deformations resulting from column removal. The effects of various parameters on building response are studied such as the location of the removed column, method of column removal, and time of column removal during the earthquake.

3. Building Description

The building used in this study is a six-storey reinforced concrete frame building (G+5), with four bays of (5 m) in X-direction and three bays of (5 m) in Y-direction, as shown in Figure 1. The size of the building in plan is (20 m x 15 m). The height of the ground floor is (3.5 m) and the other stories height is (3 m), giving a total height of (18.5 m). The building supports at the base are assumed as fixed supports. Concrete compressive strength is ($f'_c = 30 \text{ N/mm}^2$), the yield stress of steel reinforcement is ($f_y = 420 \text{ N/mm}^2$), and the modulus of elasticity for concrete and steel are ($E_c = 25.74 \text{ GPa}$) and ($E_s = 200 \text{ GPa}$), respectively.

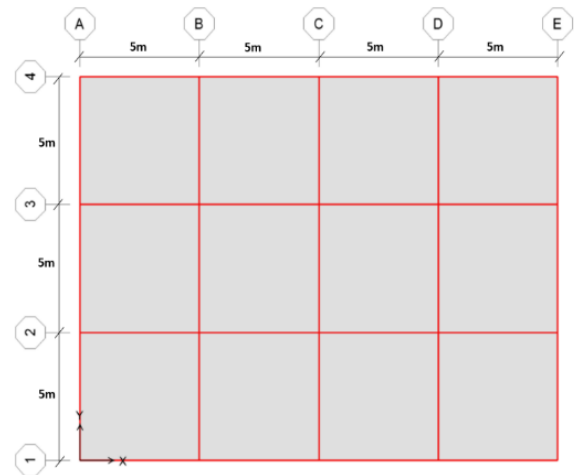

a. Plan dimensions

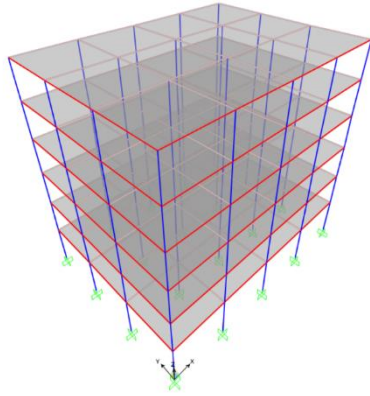

b. Three-dimensional model
Figure 1. Model for the studied building.

In addition to the self-weight of the structural components, the gravity loads applied to the building are presented in Table 1.

Table 1. Gravity loads

| Load | Typical stories | Roof story |
|-----------|---------------------|-----------------------|
| Dead load | 2 kN/m ² | 2 kN/m ² |
| Live load | 4 kN/m ² | 1.5 kN/m ² |
| Wall load | 12 kN/m | 5 kN/m |

The structure is designed via SAP2000 according to ACI 318-11. The dimensions of beams and columns for all stories are taken as (300 mm x 500 mm) and (500 mm x 500 mm), respectively. Slab thickness is taken as (150 mm) with two layers of reinforcement, to study the effect of slab on the stiffness and response of the structure as well as to include catenary action provided by the slab in progressive collapse.

4. Progressive Collapse Analyses

4.1. Column Removal Modeling

Two column removal scenarios are used to simulate the losing of column during an earthquake (sudden and in steps). The nonlinear staged construction feature in SAP2000 is adopted to model both scenarios. This feature allows modifying the structure during nonlinear analysis. The gradual removal of the column during an earthquake is approximated by removing the column in several steps. This is done by replacing the column to be removed with many secondary columns with equivalent flexural and shear stiffness. Removing the secondary column at a specific time represents the reduction in the stiffness of the column due to the earthquake. Therefore, the removal of the last secondary column means the total failure of the column is caused by the earthquake. In this work, the column is removed in two and four steps, with a linear reduction in flexural and shear stiffnesses of the

column to be removed in each step, as shown in Figure 2.

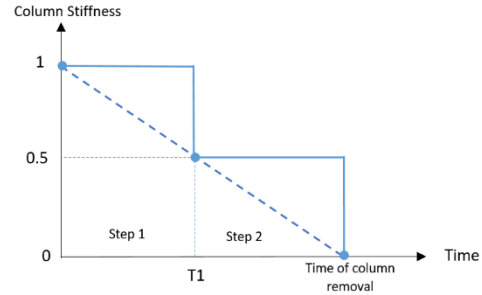

a. remove column in 2-steps

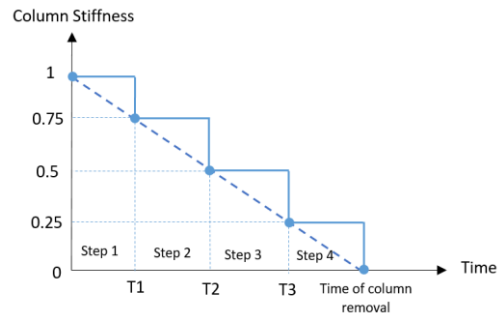

b. Remove column in 4-steps

Figure 2. Remove column in steps.

5. Analysis Procedure

Nonlinear dynamic analysis (time history analysis) is used to investigate the response of the structure for losing a column during the earthquake. In addition to seismic load, the load combination for the gravity loads is used as per (GSA 2013) and (DOD 2005) guidelines which is (1.2 DL + 0.5 LL) where (DL) is the dead load and (LL) is the live load. The earthquake used is an actual ground motion record of El Centro, California in 1940, North-South component. The building is subjected to the acceleration values in the X-direction during (10 sec) at a time interval of (0.02 sec). The time of column removal during the earthquake is assumed based on the significant change in acceleration direction. Two column removal time is used to study the effect of removing time on the response of the structure. The first time of a complete column removal is assumed at (1.2 sec) and the second time at (1.6 sec) as shown in Figure 3.

The location of the removed column is specified according to the General Services Administration (GSA) guidelines. The columns are removed from the ground floor one at a time (external column, corner column, and internal column) as shown in Figure 4. Therefore, the studied cases will be as shown in Table 2.

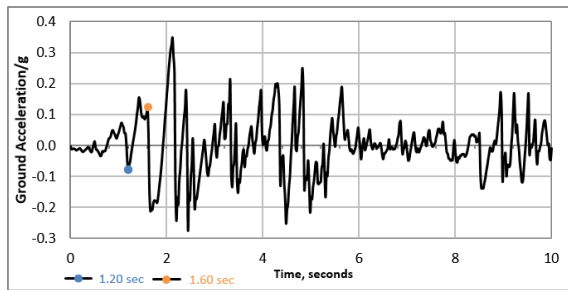

Figure 3. El Centro earthquake, California in 1940.

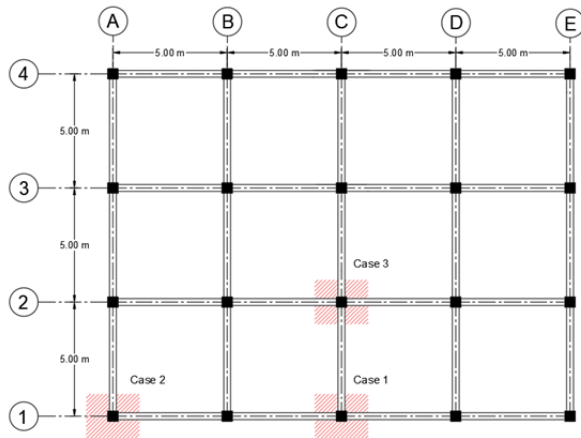

Figure 4. Location of the removed columns.

Table 2. Studied cases.

| Case No. | Location of the removed column | Time of column removal | Column removal scenario |
|----------|--------------------------------|------------------------|-------------------------|
| Case-1 | External column (C-1) | 1.2 sec | Sudden |
| | | | In 2-steps |
| | | 1.6 sec | In 4-steps |
| | | | Sudden |
| Case-2 | Corner column (A-1) | 1.2 sec | Sudden |
| | | | In 2-steps |
| | | 1.6 sec | In 4-steps |
| | | | Sudden |
| Case-3 | Internal column (C-2) | 1.2 sec | Sudden |
| | | | In 2-steps |
| | | 1.6 sec | In 4-steps |
| | | | Sudden |

6. Acceptance criteria

The plastic hinge rotation capacity of beams and columns is used as an acceptance criterion to evaluate the nonlinear dynamic analysis results. The rotation capacity depends on cross-section properties and reinforcement details at hinge location. The plastic hinges are assigned at both ends of beams and columns. The plastic hinges stages can be defined by a force-displacement (moment-rotation) curve introduced by FEMA 356 [12] and ASCE 41 [14], as shown in Figure 5. SAP2000 uses (ASCE 41-13) [14] to calculate the plastic hinge rotation at each performance level. Where (IO) is immediate occupancy level, (LS) is life safety level and (CP) is collapse prevention level, and (C) is a collapse point. Points D and E represent the residual capacity and the total failure of the hinge respectively.

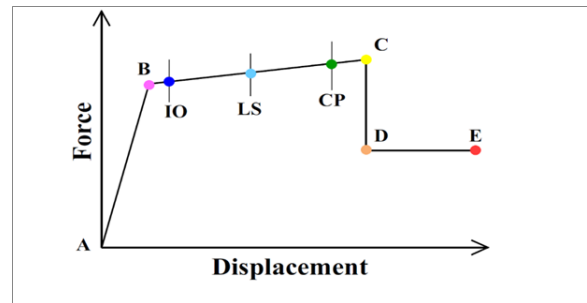

Figure 5. Plastic hinge performance levels.

7. Results and discussion

The progressive collapse analysis results of the studied cases are given as follows:

1. The distribution of plastic hinges and their performance levels at different times until the end of the earthquake or building collapse for the case of external column removal with different scenarios, and based on column removal times of (1.2 sec) and (1.6 sec) are shown in Figures 6 and 7, respectively. The failure mechanism of the other two cases, corner column and internal column removal, are similar to case-1 but the differences are in the collapse time so it is not shown.
2. The maximum base shear in X-direction, for the three locations of the removed column and removing scenarios and based on column removal times of (1.2 sec) and (1.6 sec), are shown in Figure 8. For the collapsed buildings, the values represent the maximum base shear before the collapse.
3. The maximum story displacements in X-direction before the building collapse, for the three locations of the removed column and removing scenarios and based on column removal times of (1.2 sec) and (1.6 sec), are given in Figure 9.

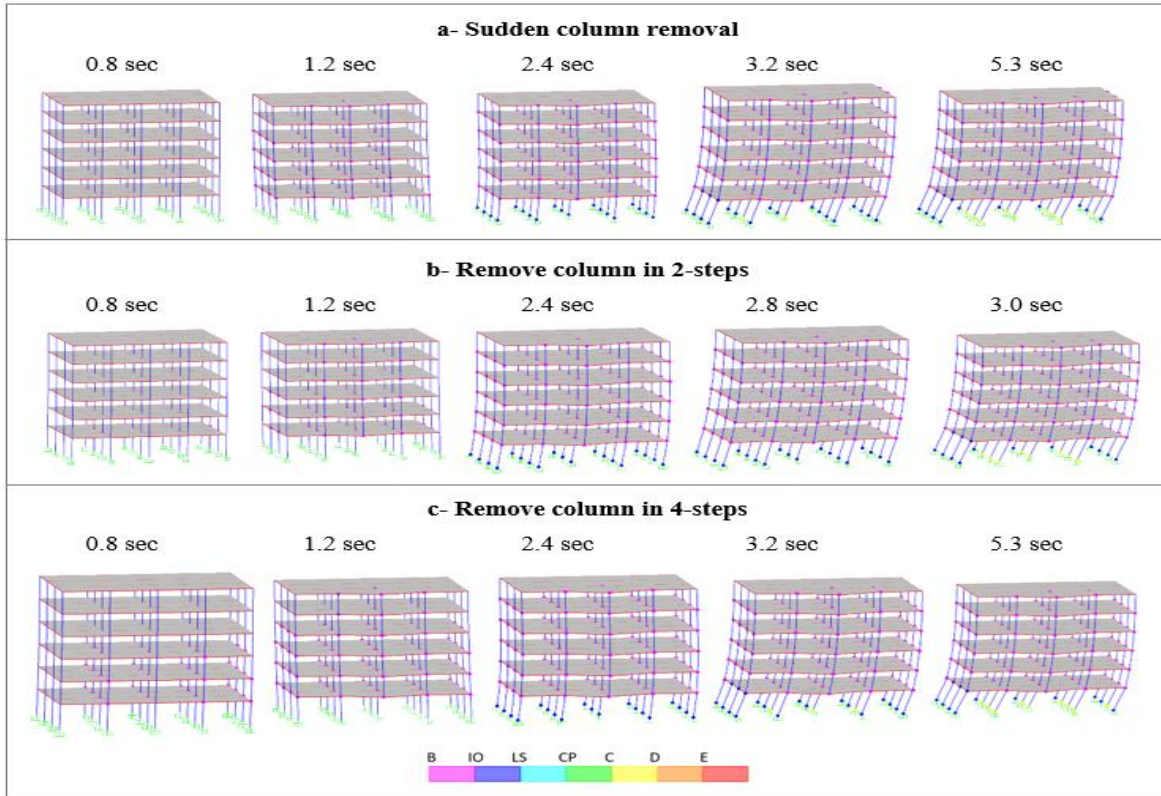

Figure 6. The distribution of plastic hinges and their performance for the column removal time of 1.2 sec (Case-1).

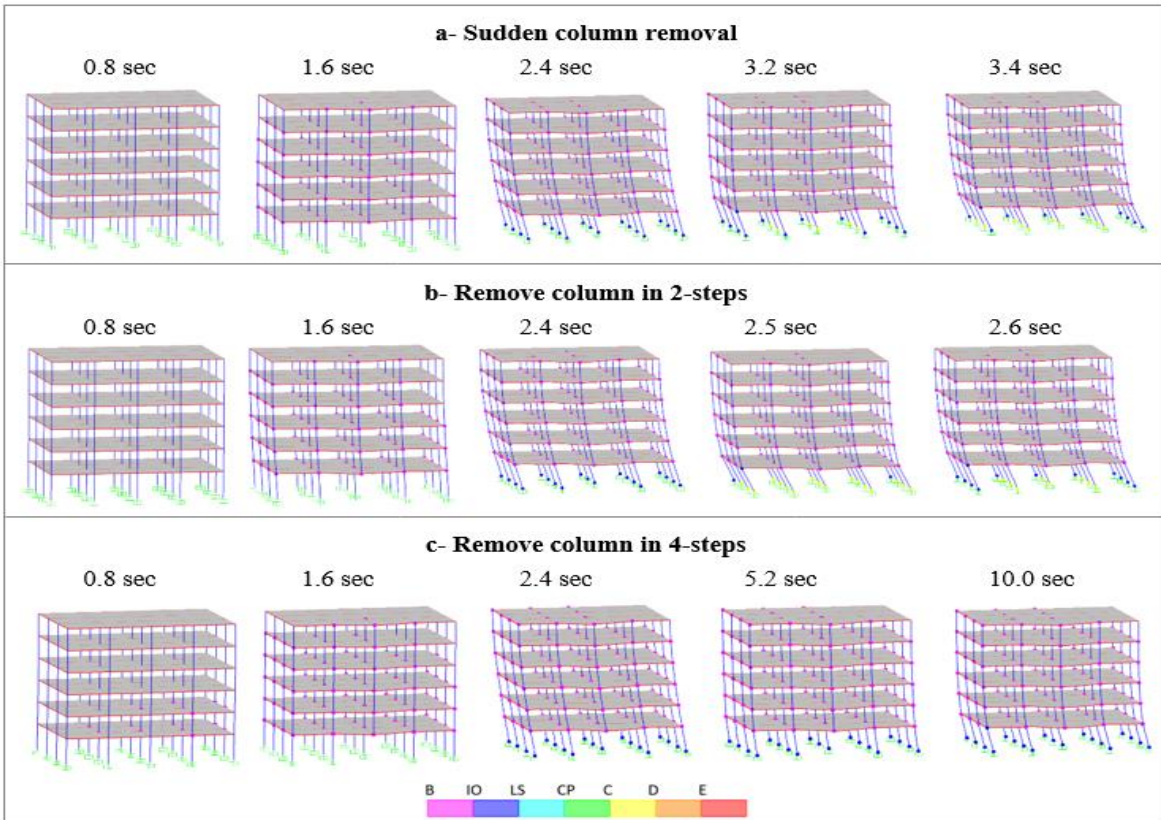

Figure 7. The distribution of plastic hinges and their performance for the column removal time of 1.6 sec (Case-1).

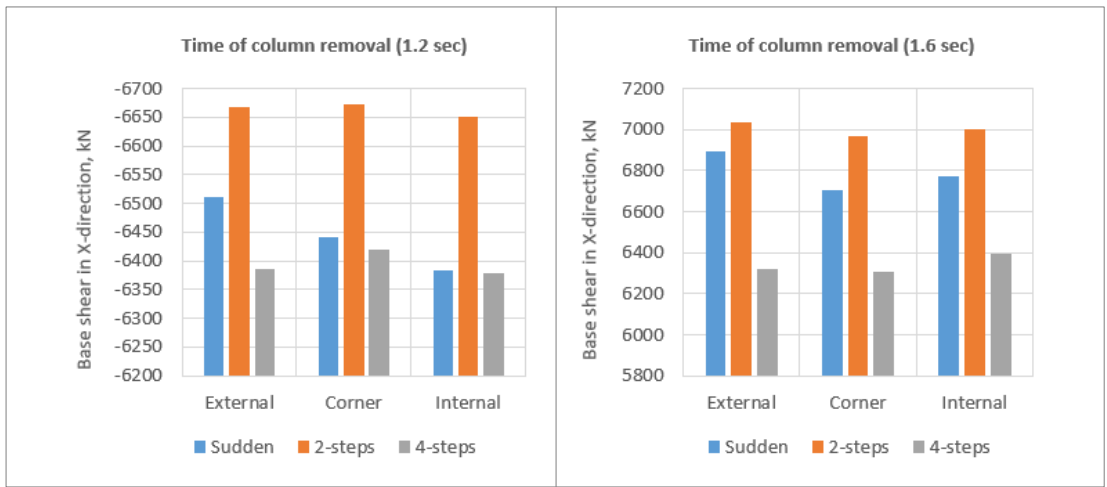

Figure 8. Maximum base shear in X-direction.

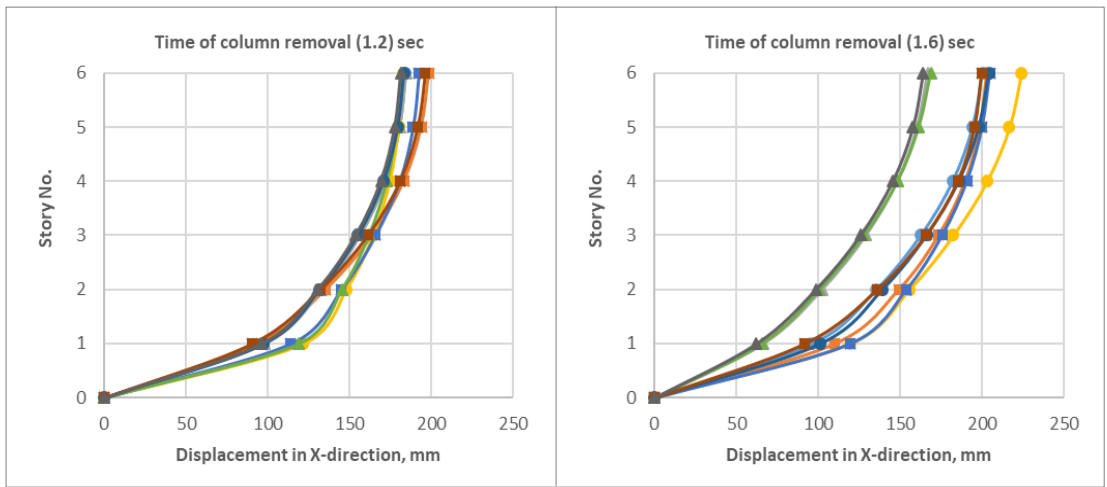

Figure 9. Maximum story displacements in X-direction.

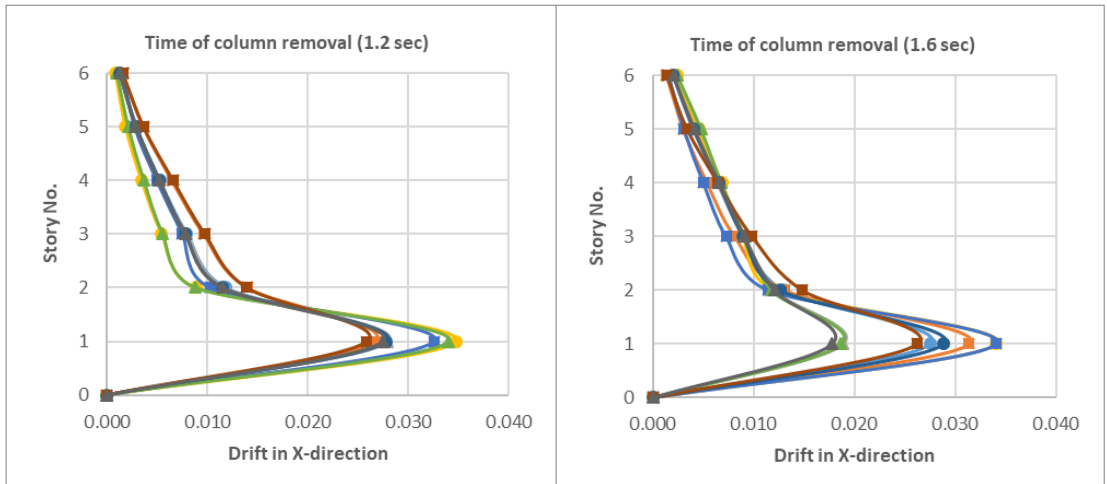

Figure 10. Maximum story drift ratio in X-direction.

Where:



4. The maximum story drift ratio in X-direction before the building collapse, for the three locations of the removed column and removing scenarios and based on column removal times of (1.2 sec) and (1.6 sec), are shown in Figure 10.

5. The maximum vertical displacement at the top joint of the removed column, for the three locations of the removed column and removing scenarios and based on column removal times of (1.2 sec) and (1.6 sec), are given in Figure 11.

6. The remaining analysis results for the three studied cases base on column removal times of (1.2 sec) and (1.6 sec), which including (collapse time, roof horizontal displacement, maximum story drift ratio, number of plastic hinges, their performance levels before the building collapse, rotations of plastic hinges at the base of ground floor columns adjacent to the removed column that are presented in Table 3, and percentages of increase in axial load after column removal for the adjacent columns), are summarized in Table 4 and 5, respectively.

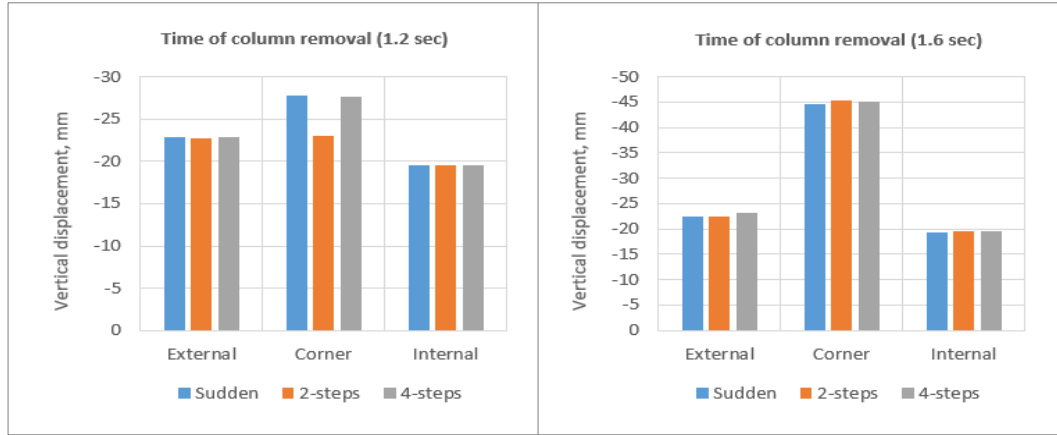

Figure 11. Maximum vertical displacement at the top joint of the removed column.

Table 3. Location of columns adjacent to the removed column.

| Removed Column (x, y) | Neighboring columns. | | | |
|-----------------------|----------------------|---------------------|---------------------|---------------------|
| | Left col. (x-5, y) | Right col. (x+5, y) | Above col. (x, y+5) | Below col. (x, y-5) |
| C-1 | B-1 | D-1 | C-2 | - |
| A-1 | - | B-1 | A-2 | - |
| C-2 | B-2 | D-2 | C-3 | C-1 |

Table 4. Analysis results for the three studied cases base on column removal time of (1.2 sec).

| Parameter | Column removal scenario | | | | | | | | | |
|----------------------------|-------------------------|-------|-------|---------|-------|-------|---------|-------|-------|-------|
| | Sudden | | | 2-Steps | | | 4-Steps | | | |
| | 1 | 2 | 3 | 1 | 2 | 3 | 1 | 2 | 3 | |
| Collapse time (sec) | 5.3 | 8.3 | 5.3 | 3.0 | 3.6 | 3.0 | 5.3 | 8.4 | 5.3 | |
| Roof horizontal disp. (mm) | 184 | 183 | 183 | 199 | 192 | 196 | 185 | 182 | 181 | |
| Max. story drift ratio | 0.028 | 0.035 | 0.028 | 0.027 | 0.033 | 0.026 | 0.028 | 0.034 | 0.028 | |
| Number of plastic hinges | B-IO | 281 | 266 | 286 | 269 | 257 | 281 | 273 | 262 | 281 |
| | IO-CP | 33 | 13 | 35 | 39 | 21 | 41 | 32 | 17 | 34 |
| | > CP | 9 | 26 | 10 | 8 | 22 | 6 | 9 | 22 | 10 |
| Column at x-5, y | Rotation (rad) | 0.025 | - | 0.026 | 0.023 | - | 0.022 | 0.026 | - | 0.025 |
| | Load increase (%) | 28.06 | - | 21.05 | 28.29 | - | 19.76 | 22.52 | - | 15.52 |
| Column at x+5, y | Rotation (rad) | 0.025 | 0.036 | 0.028 | 0.024 | 0.033 | 0.024 | 0.026 | 0.035 | 0.024 |
| | Load increase (%) | 41.22 | 48.33 | 26.88 | 35.55 | 40.00 | 22.75 | 33.05 | 42.72 | 20.02 |
| Column at x, y+5 | Rotation (rad) | 0.027 | 0.033 | 0.028 | 0.025 | 0.031 | 0.024 | 0.027 | 0.032 | 0.027 |
| | Load increase (%) | 22.41 | 34.41 | 23.41 | 20.43 | 32.85 | 20.70 | 17.86 | 30.48 | 16.28 |
| Column at | Rotation (rad) | - | - | 0.028 | - | - | 0.024 | - | - | 0.028 |

| | | | | | | | | | | |
|---------|-------------------|---|---|-------|---|---|-------|---|---|-------|
| x , y-5 | Load increase (%) | - | - | 31.16 | - | - | 29.39 | - | - | 22.41 |
|---------|-------------------|---|---|-------|---|---|-------|---|---|-------|

Table 5. Analysis results for the three studied cases base on column removal time of (1.6 sec).

| Parameter | | Column removal scenario | | | | | | | | |
|----------------------------|-------------------|-------------------------|--------|--------|---------|--------|--------|---------|--------|--------|
| | | Sudden | | | 2-Steps | | | 4-Steps | | |
| | | 1 | 2 | 3 | 1 | 2 | 3 | 1 | 2 | 3 |
| Collapse time (sec) | | 3.4 | 3.5 | 3.4 | 2.6 | 3.2 | 2.5 | - | - | - |
| Roof horizontal disp. (mm) | | 200 | 224 | 204 | 203 | 205 | 200 | 167 | 169 | 164 |
| Max. story drift ratio | | 0.028 | 0.034 | 0.029 | 0.031 | 0.034 | 0.026 | 0.019 | 0.019 | 0.018 |
| Number of plastic hinges | B-IO | 286 | 290 | 291 | 282 | 285 | 290 | 298 | 303 | 304 |
| | IO-CP | 37 | 17 | 30 | 35 | 25 | 46 | 37 | 35 | 35 |
| | > CP | 10 | 25 | 16 | 20 | 26 | 6 | 0 | 0 | 0 |
| Column at x-5 , y | Rotation (rad) | -0.025 | - | -0.027 | -0.031 | - | -0.023 | -0.016 | - | -0.015 |
| | Load increase (%) | 29.69 | - | 21.97 | 26.34 | - | 19.23 | 33.68 | - | 20.57 |
| Column at x+5 , y | Rotation (rad) | -0.025 | -0.034 | -0.029 | -0.031 | -0.035 | -0.024 | -0.016 | -0.016 | -0.014 |
| | Load increase (%) | 40.44 | 44.82 | 26.35 | 39.08 | 47.91 | 24.58 | 22.61 | 22.44 | 15.54 |
| Column at x , y+5 | Rotation (rad) | -0.027 | -0.033 | -0.029 | -0.032 | -0.034 | -0.024 | -0.014 | -0.015 | -0.014 |
| | Load increase (%) | 22.16 | 35.17 | 23.43 | 20.53 | 33.43 | 20.68 | 17.90 | 30.43 | 16.17 |
| Column at x , y-5 | Rotation (rad) | - | - | -0.029 | - | - | -0.024 | - | - | -0.014 |
| | Load increase (%) | - | - | 33.43 | - | - | 29.08 | - | - | 22.19 |

For all studied locations, times, and removal scenarios, it is observed that the mechanism of progressive collapse under the earthquake effect is started by the plastic hinges formation in the beams of the ground floor and their propagation towards the beams of the other stories, as the earthquake persist. Then, the plastic hinges are formed at the bases of ground floor columns. When these hinges are reached to immediate occupancy level (IO), the plastic hinges are started to form at the top joint of the ground floor columns and some columns of the other stories. The collapse plastic hinges are started to form at the bases of the ground floor columns first, when the top hinges reached to immediate occupancy level, where the building is collapsed when most hinges at the bases of ground floor columns are reached to collapse levels as shown in Figures 6 and 7. It is apparent from Figure 8 that, the maximum base shear for the (2-steps) removal scenario is greater than their counterparts for other scenarios for all locations of removed column and removal times. It is greater than sudden and (4-steps) removal scenarios with an average by (3.6%), for column removal time of (1.2 sec). It is greater than sudden and (4-steps) removal scenarios with an average by (3.1%) and (10.4%), respectively, for column removal time of (1.6 sec). It is evident from Figure 10 that, the maximum story drift before the building collapses is occurred at the ground floor in all times and scenarios of column removal, due to the formation of collapse plastic hinges at the column bases of

this story. Corner column removal has given the maximum vertical displacement at the top joint of the removed column in all times and scenarios of column removal as shown in Figure 11. The vertical displacement at the top joint of the removed column has not affected much by the column removal scenario. It is observed from Tables 4 and 5 that, removing the column in two steps records the fastest collapse, for all studied locations of removed column and removal times. In case of removing the column in (4-steps) at (1.6 sec), no collapse hinges are detected and the building has not collapsed, regardless of the location of the removed column. The number and distribution of plastic hinges at different times of the earthquake, for the three-column removal locations and scenarios, are different. This is attributed to the intended stiffness reduction of the column to be removed and its synchronization with the applied acceleration. The rotation values of plastic hinges at the bases of columns adjacent to the removed column are approximately equal for each column removal scenario. The percentages of increase in axial load after column removal for the adjacent columns reflect the contribution of each column in the redistribution of the load carried by the removed column.

8. Conclusions

Based on the results that have been obtained from this study, the following conclusions can be drawn:

I- The selected column removal time and scenario greatly affect the response of building, because they are influenced by the variable applied excitation. It is not possible to isolate their effects, except for an idealized loading but not a random one like an earthquake.

II - Based on the used building configuration and the earthquake characteristics, the two steps column removal scenario is the most dangerous scenario for all locations of the removed column.

III- The building collapses during an earthquake when all or most of the hinges at the bases of the ground floor columns reached to collapse level.

IV- Irrespective of the removed column location, the formation of collapse plastic hinges is started from the bases of the internal columns of the ground floor. Those columns usually carry higher axial loads and have less rotation capacities.

V- Although, removing the column from long direction or the interior column, produces the most intensive effect, the slight differences in number of plastic hinges for the various locations of the removed columns, do not control collapse time.

VI- The roof horizontal displacements and the maximum drift ratios were almost similar. Removal of the corner column has the strongest effect on the vertical displacement of the top joint of the removed column.

VII - Column removal leads to slight and almost similar rotations and redistributed uneven load increases in the adjacent columns. The scenario of removal does not affect the rank of columns regarding load increase ratios.

References

- [1] General Service Administration (GSA), (2003) "Progressive Collapse Analysis and Design Guidelines for New Federal Office Buildings and Major Modernization Projects", US General Service Administration: Washington, DC.
- [2] Department of Defense (DoD) (2005), "Unified Facilities Criteria (UFC), Design of Buildings to Resist Progressive Collapse", UFC 4-023-03.
- [3] British Standard, B. S. 8110 (1997) "Structural use of concrete-part 1. Code of practice for design and construction", British Standards Institution, London.
- [4] ACI Committee. (2008) "Building code requirements for structural concrete (ACI 318-08) and commentary" American Concrete Institute.
- [5] ASCE. (2005)"Minimum Design Loads for Buildings and Other Structures: ASCE/SEI Standard 7-05", American Society of Civil Engineers.
- [6] Marjanishvili, Shalva, and Elizabeth Agnew., (2006), "Comparison of Various Procedures for Progressive Collapse Analysis", Journal of Performance of Constructed Facilities, 20.4, pp. 365-374.
- [7] Tsai, Meng-Hao, and Bing-Hui Lin., (2008), "Investigation of Progressive Collapse Resistance and Inelastic Response for an Earthquake-Resistant RC Building Subjected to Column Failure", Engineering structures, 30.12, pp. 3619-3628.
- [8] Said, Aly, Ahmad Saad, and Ying Tian, (2010),"Comparison of Different Standards for Progressive Collapse Evaluation Procedures" Challenges, Opportunities and Solutions in Structural Engineering and Construction, London, ISBN 978-0-415, pp. 291-296.
- [9] Patel, B. R., (2014), "Progressive Collapse Analysis of RC Buildings Using Non -Linear Static and Non - Linear Dynamic Method", International Journal of Emerging Technology and Advanced Engineering, pp. 503-507.
- [10] Raparla, Harinadha B., and R. Pradeep Kumar, (2015), "Progressive collapse analysis of RC buildings subjected to seismic loads".
- [11] Elshaer, A., Mostafa, H. and Salem, H., (2016), "Progressive Collapse Assessment of Multistory Reinforced Concrete Structures Subjected to Seismic Actions", KSCE Journal of Civil Engineering, 21(1), pp.184-194.
- [12] Federal Emergency Management Agency (FEMA 356), (2000), "Prestandard and commentary for the seismic rehabilitation of build-

- ings", American Society of Civil Engineers (ASCE).
- [13] General Service Administration (GSA), (2013) "Alternate path analysis & design guidelines for progressive collapse resistance", GSA Guidelines.
- [14] ASCE, (2013), "ASCE/SEI 41-13: Seismic Evaluation and Retrofit of Existing Buildings", American Society of Civil Engineers.
- [15] CSI. (2015), "Analysis reference manual for SAP2000, ETABS, SAFE and CSiBridge" Computers and Structures, Inc., Berkeley, CA, USA.